

- Geosys
- Advanced Ag Solutions
- TOPCON
- AgSense
- iCropTrak/Cogent 3D
- Sensefly
- SoilMap
- ScoutPro
- MyAg Central
- Kawak Aviation Technologies
- AgSource
- ESRI
- AgGateway
- Case IH
- AgRenaissance Software
- Geonics
- I.F.A.R.M.
- ZedX, Inc.
- AgWorks
- Valley Irrigation
- MagicTec
- SATSHOT/Agri Images
- IPNI
- AUVIS
- OnFarm Systems
- Ag Robotics
- WinField
- SSI
- MapShots
- AgLeader
- AGCO Corporation
- DuPont Pioneer
- PrecisionAg
- Climate Corporation
- Advanced Reconnaissance Corp
- John Deere
- Veris Technologies
- SST Software
- Midwest Laboratories
- The Fertilizer Institute
- Climate Corporation
- Norac
- My Way RTK
- AutoCopter
- Agtelligent-Mixmate
- Trimble
- Capstan
- Spectrum
- CDMS
- Crop IMS
- SGS North America
- Farmers Edge
- AgJunction
- Raven
- Agrian
- Agjunction
- Geringhoff
- Hexagon Geospatial
- CDMS
- Arag/Salvarani
- Ag-Tester
- PAQ Interactive
- Volt Aerial
- AgriNews
- AgSync
- GeoVantage
- Phytech
- Iteris, Inc.
- XS Inc.
- Back 40 Precision
- New Holland Agriculture
- dataThresh

[www.infoag.org](http://www.infoag.org)



The  
**InfoAg**  
Conference

July 28 – 30, 2015

St. Louis Union Station Hotel  
A Doubletree by Hilton • St. Louis, MO

[WWW.INFOAG.ORG](http://WWW.INFOAG.ORG)

SHOW ORGANIZERS



**CropLife**

**PRECISIONAg**

## How to Register

Each exhibitor receives two (2) complimentary full conference registrations with each 10' x 10' booth space that is purchased. Additional exhibit hall passes for booth personnel can be purchased for \$250.00 per person. Additional full conference registrations can also be purchased, if desired.

Exhibitor registration information will be sent via email to all exhibitors prior to the show.

Questions on exhibitor registration, can be directed to Quentin Rund at 217.762.7955 or email at [registration@infoag.org](mailto:registration@infoag.org)



## Exhibitor Services

Heritage Exposition Services is the official exhibitor services contractor for the InfoAg 2015 Conference. Heritage Expo will email exhibitors a user-specific log-in and password in order to access their online, web store. This 2015 InfoAg exhibitor support site will include forms for ordering booth furnishings and booth material shipping and receiving instructions for both advance and show site shipping.

### Heritage Exposition Services

620 Shenandoah Avenue  
St. Louis, MO 63104  
P: 800.360.4323 F: 314.534.8050  
[www.heritageexpo.com](http://www.heritageexpo.com)

### Electrical/Internet Services

Electrical and Internet service will be provided by the St. Louis Union Station Doubletree Hotel engineering department. Order forms for these services will be included in the exhibitor service manual distributed by Heritage Expo and should be submitted directly to the hotel.

### Exhibit Sales Contacts:

**Dan Bellanger**  
CropLife  
P: 636.244.3310  
E: [dan@croplife.com](mailto:dan@croplife.com)

**Rick Welder**  
CropLife  
P: 440.602.9147  
E: [rick@croplife.com](mailto:rick@croplife.com)

**Sal Settecase**  
CropLife  
P: 440.602.9166  
E: [sal@croplife.com](mailto:sal@croplife.com)

### Send completed contracts to:

**April Host**  
CropLife  
37722 Euclid Avenue  
Willoughby, OH 44094  
P: 440-602-9221  
F: 440-602-9363  
E: [ahost@meistermedia.com](mailto:ahost@meistermedia.com)

The  
**InfoAg**  
Conference  
[www.infoag.org](http://www.infoag.org)

July 28 – 30, 2015

St. Louis Union Station Hotel  
A Doubletree by Hilton  
St. Louis, MO

# WHY SHOULD YOU EXHIBIT AT INFOAG 2015?

MORE THAN 1400 ATTENDEES IN 2014!

Since 1994, the InfoAg Conference has been the premier event for the discussion and advancement of precision agriculture. This event draws interest from domestic and international agriculture professionals and features a wide range of educational and networking opportunities for professionals interested in learning more about precision agriculture techniques.

The **InfoAg 2015 Conference** will focus on the application of precision technology and information management for a wide array of crops including cotton, soybeans, corn and wheat. InfoAg is the perfect venue for you to grow and deepen your market relationships and place your company's brand in front of hundreds of qualified buyers ready to do business with your company.

## Who Attends

- Growers
- Crop Consultants/Scouts
- Farm Managers
- Academic/Extension Personnel
- Government Officials



## Exhibitor Benefits

- The opportunity to meet face-to-face with hundreds of leading growers and consultants.
- A program designed with the exhibitor in mind to ensure plenty of time for networking.
- Two full conference registrations with each booth space purchased.

**Display Price:** \$1,600.00 per 10' x 10' booth

### Display Space Features:

Each booth comes furnished with the following items:

- 8' high draped back and 3' side skirting
- One (1) 6' draped table
- Two (2) folding chairs
- One (1) exhibitor identification sign 7" x 44"
- One (1) wastebasket

# INFOAG 2015 CONFERENCE EXHIBIT HALL

## InfoAg 2015 Exhibitor Map

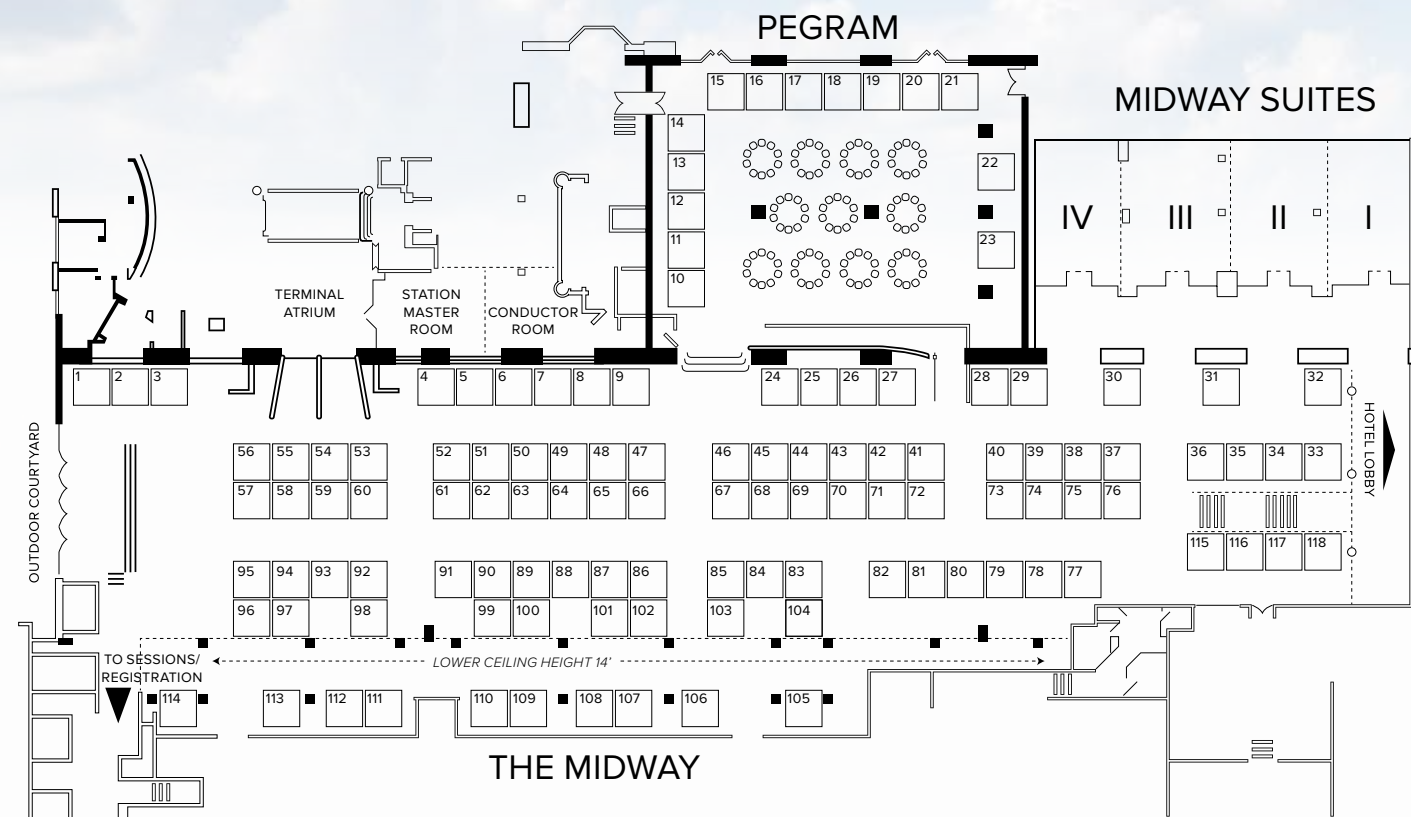

## Dedicated Exhibit Hall Hours\*

### Tuesday

July 28, 2015

11:30 am – 1:00 pm  
2:50 pm – 3:30 pm  
5:30 pm – 7:30 pm

### Wednesday

July 29, 2015

7:00 am – 8:00 am  
9:50 am – 10:30 am  
2:20 pm – 3:00 pm  
5:00 pm - 7:00pm Reception  
in the exhibit hall

### Thursday

July 30, 2015

7:00 am – 9:00 am

\*times subject to change

**Exhibitor Move In:** Monday, July 27, 2015: 1:00 pm – 7:00 pm  
Tuesday, July 28, 2015: 8:00 am – 11:00 am

**Exhibitor Move Out:** Thursday, July 30, 2015: 9:00 am - 12:00 pm

## Hotel Information

St. Louis Union Station Hotel  
1820 Market St.  
St. Louis, MO 63103

InfoAg 2015 Room Rates: \$135.00+ tax  
Reservation Deadline: July 8, 2015,  
unless sold out prior to July 8  
Phone: 855.271.3620